

SITE DATA:

- 1. TAX MAP NUMBER: 130-18-00-00-00-000-0000-0000-0000
- 2. DEVELOPER NAME: B.S.M. LLC
- 3. ADDRESS LOCATION: COUNTY SEAT HIGHWAY, DE RT 9
- 4. ZONING DISTRICT: DE RT 9
- 5. REGULATORY AGENCIES: DEPARTMENT OF TRANSPORTATION, DEPARTMENT OF ENVIRONMENTAL AND NATURE RESOURCES
- 6. BUILDING HEIGHT: 34 FEET - 3 STORES
- 7. REQUIRED LOT SIZE (SQ FT): 60 FT
- 8. PARKING: 20% OFF-STREET PARKING, 2000 SPACES
- 9. RESTAURANT: 2,000 SF
- 10. PAD SITE #1: 12,000 SF
- 11. PAD SITE #2: 12,000 SF
- 12. TRAFFIC GENERATION: 1,500 VPH

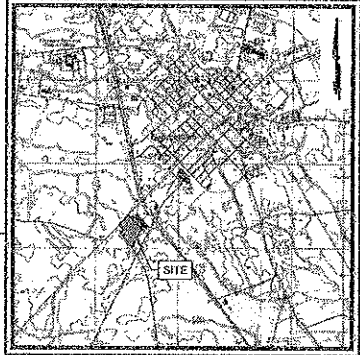

COUNTY SEAT HIGHWAY (DE RT 9 & SCR 20)
MINOR ARTERIAL - 80' RIGHT-OF-WAY

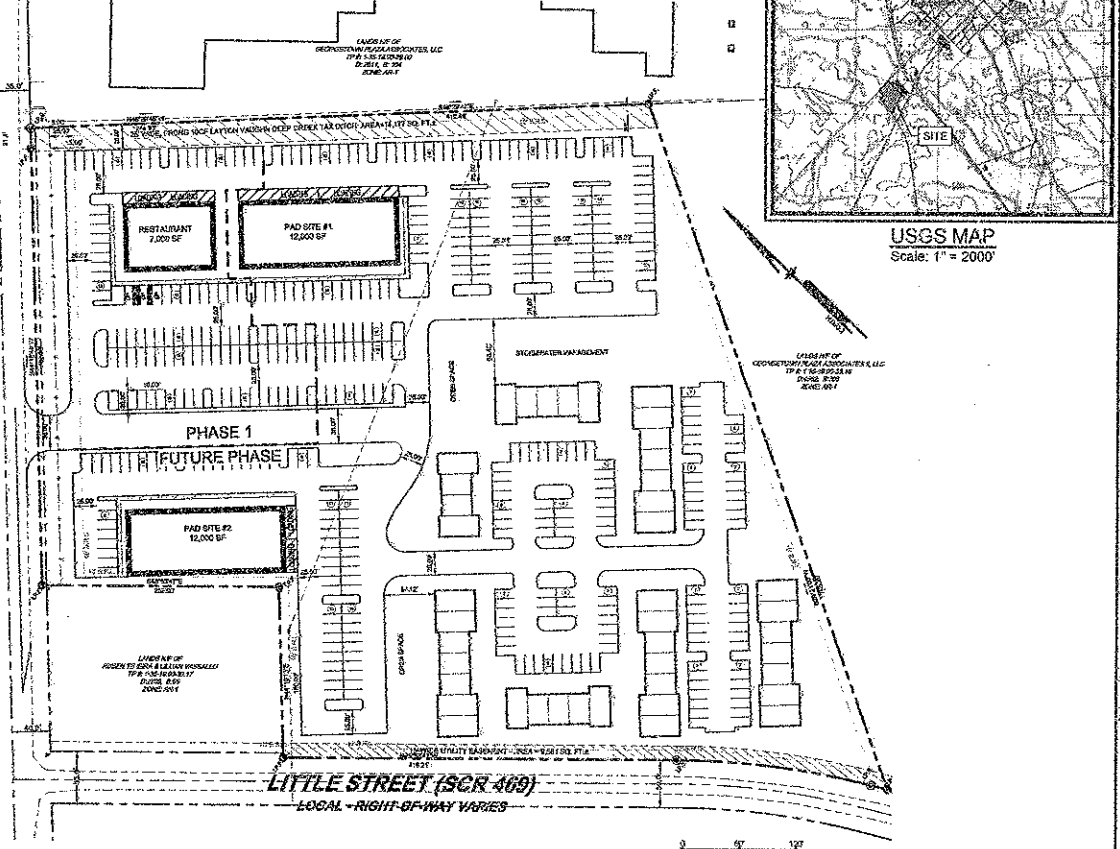

TRAFFIC GENERATION - COUNTY SEAT HIGHWAY (SCR 20)

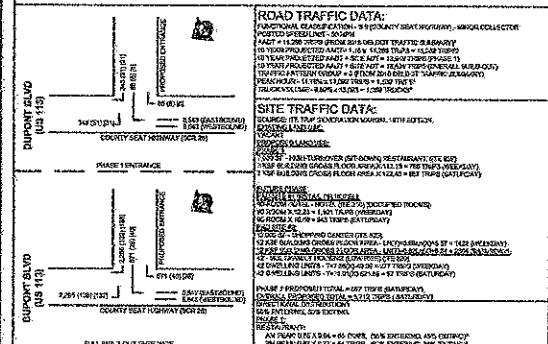

TRAFFIC GENERATION DIAGRAM

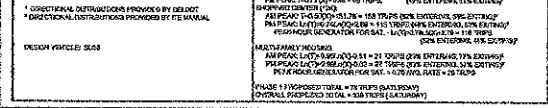

GEORGETOWN BUSINESS PARK
CONCEPT PLAN

JOHN TEAGUE
ENGINEER

NO.	DATE	REVISIONS

PROJECT: ILSEM19001
DATE: 2019-05-22

DRAWING NO.: 17100
DRAWN BY: TPJ
CHECKED BY: AXD

CS1001
SHEET 1 OF 1